

## 50-52" A-PILLAR LIGHT MOUNT

18+/20+ WRANGLER GLADIATOR JL/JT



### TOOLS REQUIRED

- T-40 Torx Bit
- #4, #5x Allen Bit
- 10mm Wrench

### SKILL LEVEL

- Novice/Intermediate
- 2 persons

Little skill level required, however, additional help is highly recommended when installing any light bar.

### TIME REQUIRED

- 1.5 Hours

Time to install this should only take about an hour and a half.

## WARNINGS/CAUTIONS BEFORE STARTING INSTALLATION

Before you install this kit – Read and understand all instructions, warnings, cautions, and notes contained in this installation instruction guide. Consult your vehicle owner's manual for proper disconnection of electrical and lifting of vehicle if required for installation of this product.

This install may require some technical skills and knowledge of basic mechanical work. If you do not feel that you are capable of performing this install please take this product to a trained professional.

After reading this guide please contact us with any questions or concerns before installing product.  
Customer Service: 855-680-9595

*DV8 Offroad is not responsible for any bodily injury or harm to you or your vehicle as a result of an improper install.*

Proper installation of this kit required knowledge of the factory recommended procedures for removal and installation of original equipment components. We recommend that the factory shop manual and any special tools needed to service your vehicle be on hand during the installation. Installation of this kit without proper knowledge of the factory recommended procedures may affect the performance of these components and the safety of the vehicle

- Always wear eye protection when operating power tools

*Inspect all contents of this package to make sure product is not damaged and all installation hardware has been included. If parts are missing from kit, please be prepared to provide the following information*

1. Name of purchase location
2. Bar Code on side of box
3. Date above bar code
4. Date inside box cover



# INSTALLATION MANUAL

Begin by unpacking all items and inspecting for missing pieces or damage. If you have any concerns, please contact the company the product was purchased from. Extra hardware may be included with the product.

## HARDWARE INCLUDED

- (4) M8x35 Tapered Allen
- (2) M6x45 Tapered Allen



**STEP 1** | Peel back the paper to reveal the adhesive side of the foam and carefully apply the foam to each bracket.



# INSTALLATION MANUAL

**STEP 2** | Use a 10mm wrench to remove the antenna.



**STEP 3** | Use a T40 torx bit to remove the three factory bolts on each side of the vehicle.

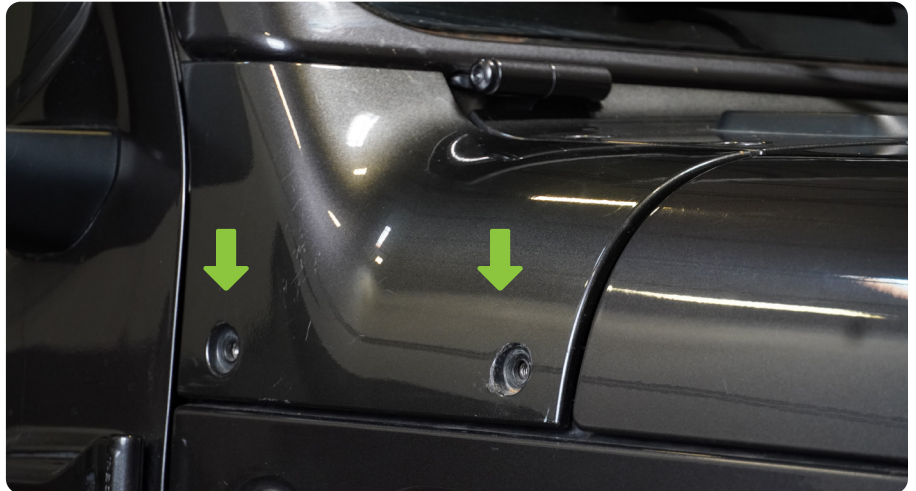

# INSTALLATION MANUAL

**STEP 4** | Secure the light bar mount to the vehicle using the provided M6 and M8 hardware with a #4 and #5 allen bit.

The M8 bolts will go on the side of the bracket and the M6 will go on top.

Repeat steps for opposite side of the vehicle, however leave one side loose until the light bar is installed (preferably the side the wiring will be ran).



# INSTALLATION MANUAL

**STEP 5** | With assistance, install the light using the hardware that was provided with the light bar.

A 52" elite series light bar is being used for this install.

**Part Number: BE52EW500W**

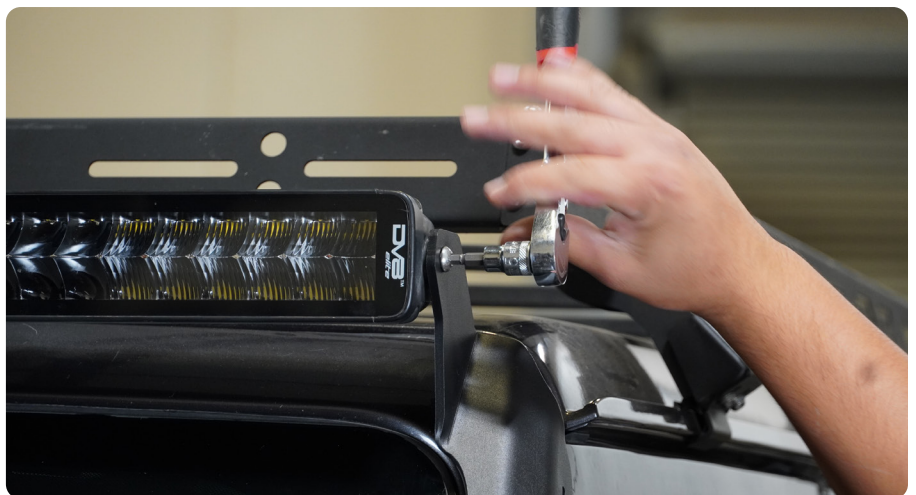

# INSTALLATION MANUAL

**STEP 6** | Tuck the wiring behind the bracket and run it down the A-pillar.

Feed the wire out of the bottom of the bracket to prepare to route it under the A-pillar body panel.

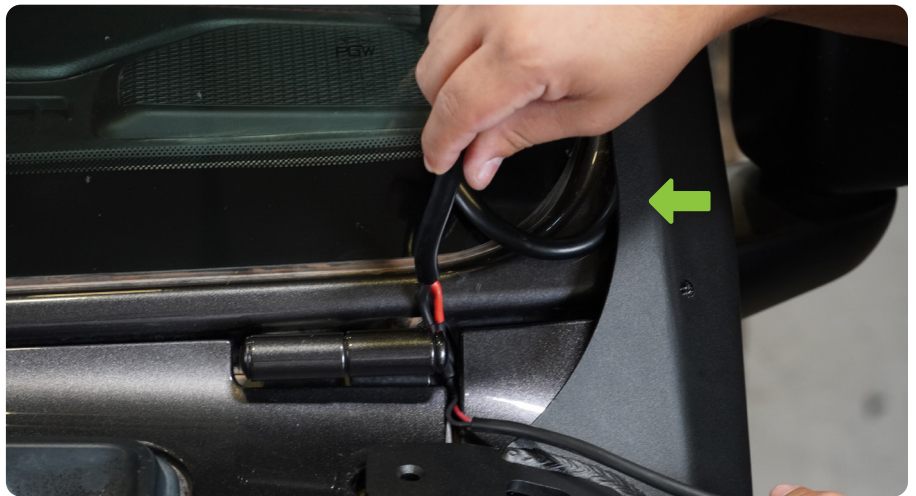

# INSTALLATION MANUAL

**STEP 7** | If installing part number: LBJL-11, then stop here and go to the install guide for LBJL-11 to continue the install.

This step is optional depending on how the wiring is routed. On this install, it was routed into the engine bay.

**Skip to step 9** if you are not routing the wiring into the engine bay.

Opening the hood may make this step easier.

With assistance, use a T40, #4, and #5 allen bit to remove one side of the light bar bracket and pull the body panel to remove it.

Continue routing the wiring into the engine bay.



**STEP 8** | Re-place the body panel and light bar bracket and secure the provided and factory hardware with a T-40 torx, #4, and #5 allen bit.

Repeat steps for opposite side of the vehicle.

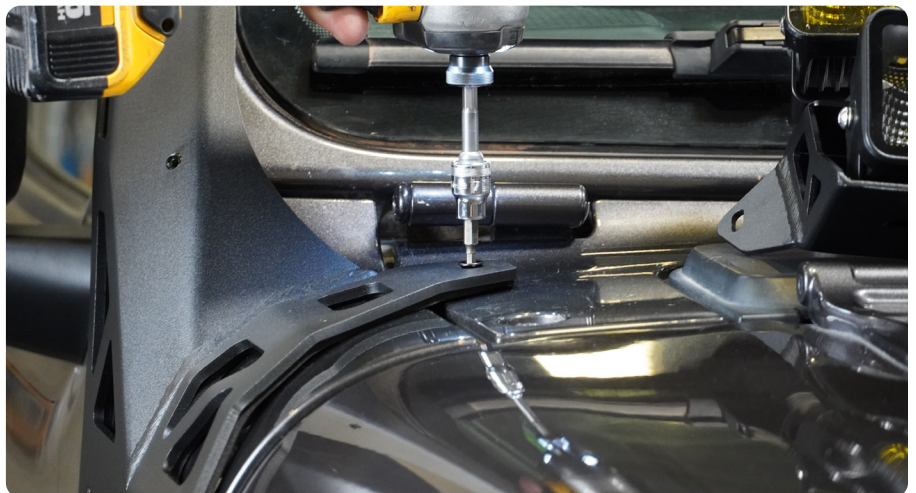

# INSTALLATION MANUAL

**STEP 9** | Re-install the antennae using a 10mm wrench.



**STEP 10** | Congrats! You are finished with the install of the 18+/20+ Wrangler/Gladiator JL/JT A-Pillar Light Bar Mount.

